

PANEL ARRANGEMENT

DRAWN FOR THE PLYWOOD SHEET
SIZE 1.22 x 2.44 m

PLYWOOD SHEETS JOINED WITH A SCARF JOINT
TEN TIMES AS LONG AS DEEP, THEN GLUED
APPLYING PRESSURE

ALL OTHER SMALL PANELS
CUT FROM SCRAPS

SIDE EDGE OF THE DECK PANEL 15–20 mm
OVERSIZED FOR MARKING ACCURATELY TO SHAPE

HOLES FOR THE MAST FITTED INTO THE SPAR
SECTION, 1 mm GAP ALL AROUND, CUT OUT
AFTER SETTING THE DECK UP AND FASTENING
TO THE KING PLANK

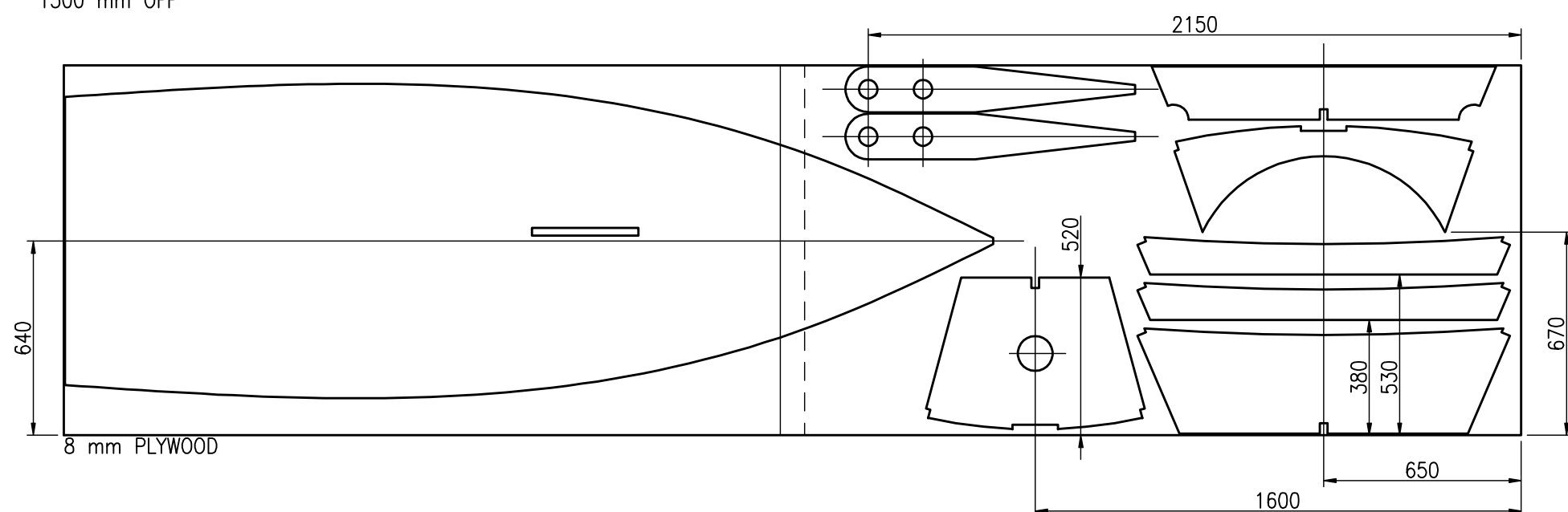
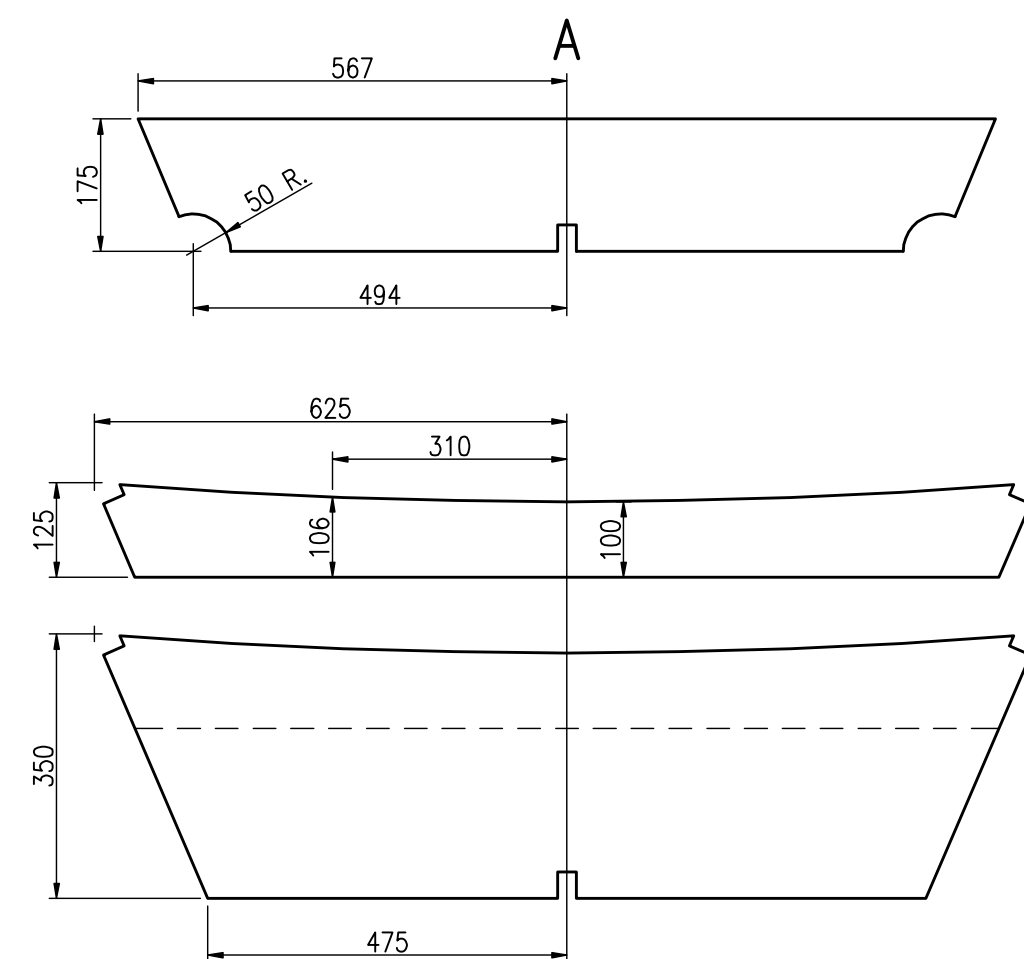
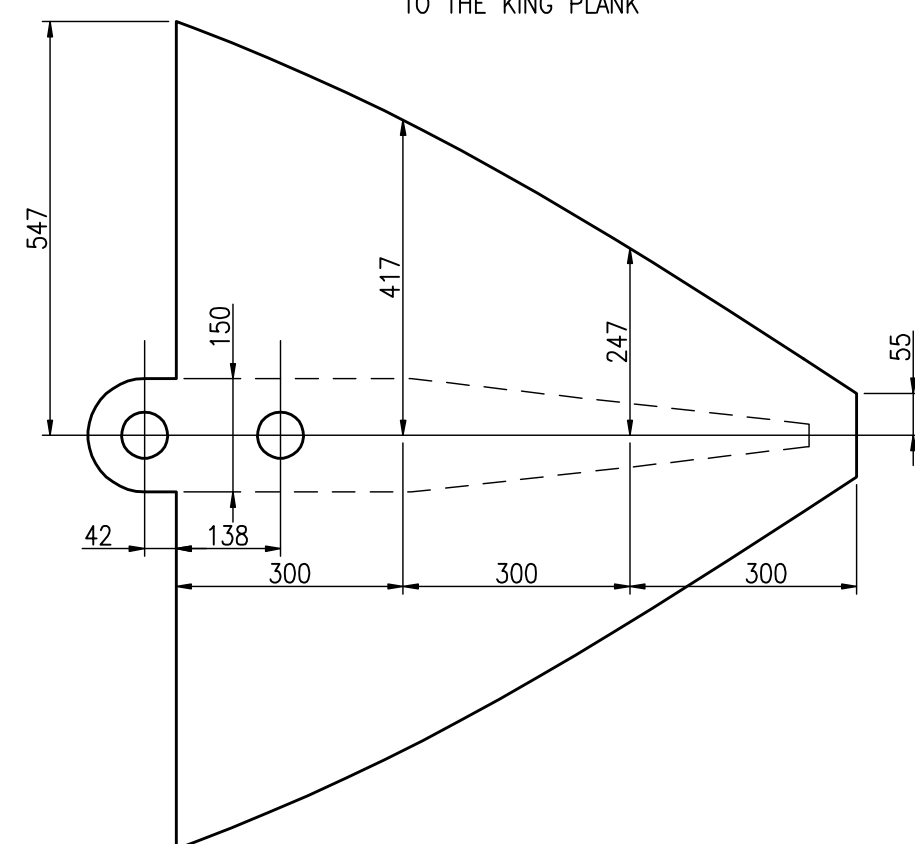
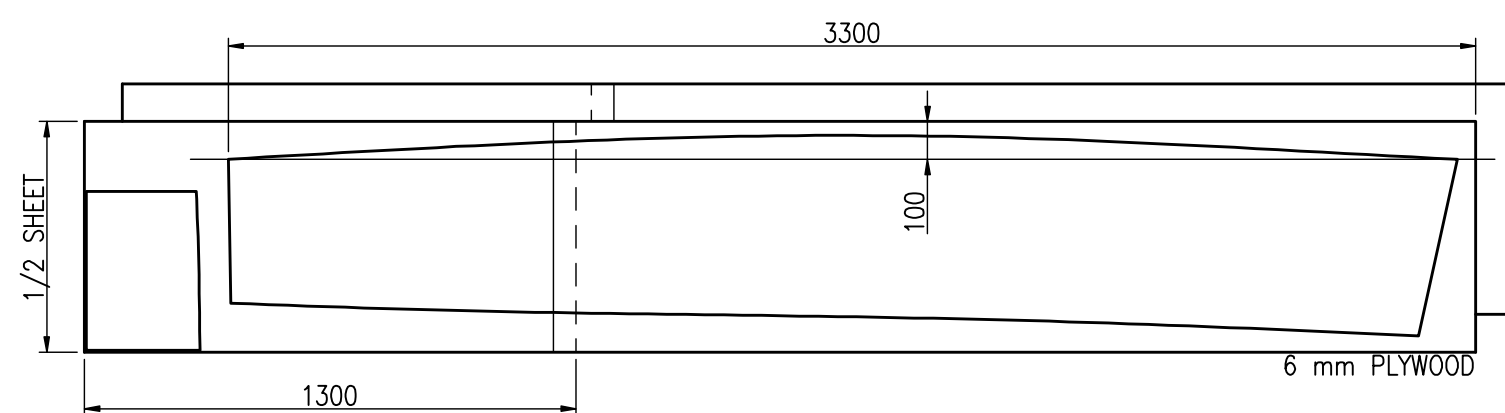
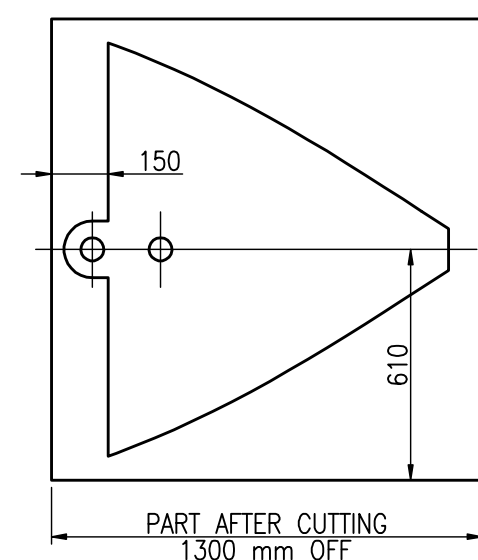

3.1m

HULL PANELS
SHEET 31.1/4, SIZE A2
SCALE 1:10, 1:20

RADOSŁAW WERSZKO
JUNE 2009, NOVEMBER 2012