

PANEL ARRANGEMENT
DRAWN FOR THE PLYWOOD SHEET
SIZE 1.22 x 2.44 m

ALL OTHER SMALL PANELS
CUT FROM SCRAPS

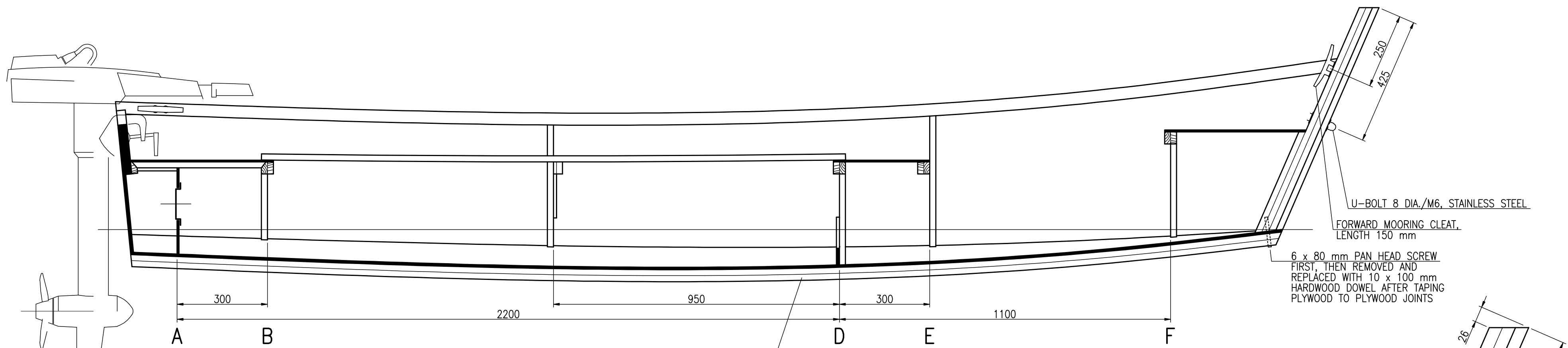

KEEL TWO LAYERS OF 20 x 40 mm GLUED TOGETHER OVER THE BUILDING STOCK BEFORE SETTING UP THE BOTTOM, THEN GLUED AND ALTERNATELY SCREWED TO BOTH PANELS WITH 3.5 x 30 mm SCREWS SPACED 75 mm, THEN TAPED INSIDE WITH RESIN AND MAT

SIDE BENCH HARDWOOD, EACH PANEL GLUED OVER A MOULD OF FIVE LAYERS OF 20 x 20 mm, FASTENED AFTER PAINTING THE HULL WITH SCREWS ONLY

BENCH SPACER 20 x 20 mm, GLUED AND DOWELLED TO PANELS WITH TWO 8 x 80 mm HARDWOOD DOWELS

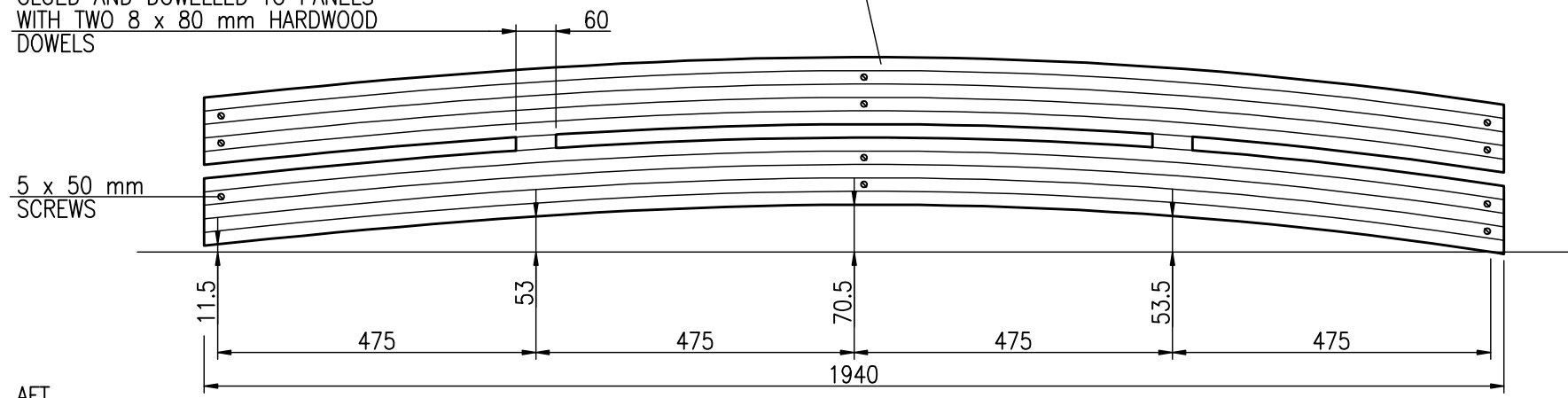

AFT MOORING CLEAT, LENGTH 150 mm

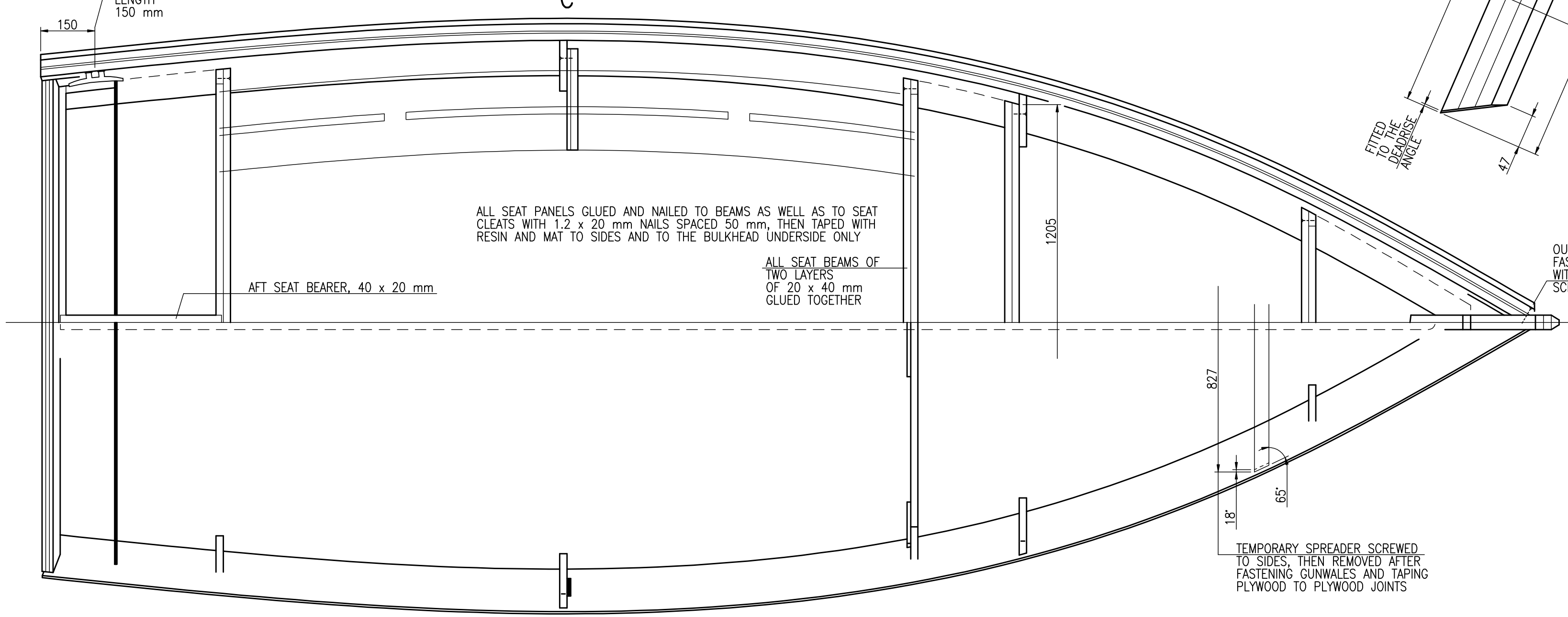

ALL SEAT PANELS GLUED AND NAILED TO BEAMS AS WELL AS TO SEAT CLEATS WITH 1.2 x 20 mm NAILS SPACED 50 mm, THEN TAPED WITH RESIN AND MAT TO SIDES AND TO THE BULKHEAD UNDERSIDE ONLY

ALL SEAT BEAMS OF TWO LAYERS OF 20 x 40 mm GLUED TOGETHER

AFT SEAT BEARER, 40 x 20 mm

U-BOLT 8 DIA/M6, STAINLESS STEEL, LENGTH 150 mm

FORWARD MOORING CLEAT, LENGTH 150 mm

6 x 80 mm PAN HEAD SCREW, FIRST, THEN REMOVED AND REPLACED WITH 10 x 100 mm HARDWOOD DOWEL AFTER TAPING PLYWOOD TO PLYWOOD JOINTS

STEM, THREE AND FOUR LAYERS OF 20 x 40 mm GLUED TOGETHER, THEN GLUED AND SCREWED TO PLANKING WITH 3.5 x 30 mm SCREWS SPACED 50 mm, THEN TAPED OUTSIDE ONLY WITH RESIN AND MAT

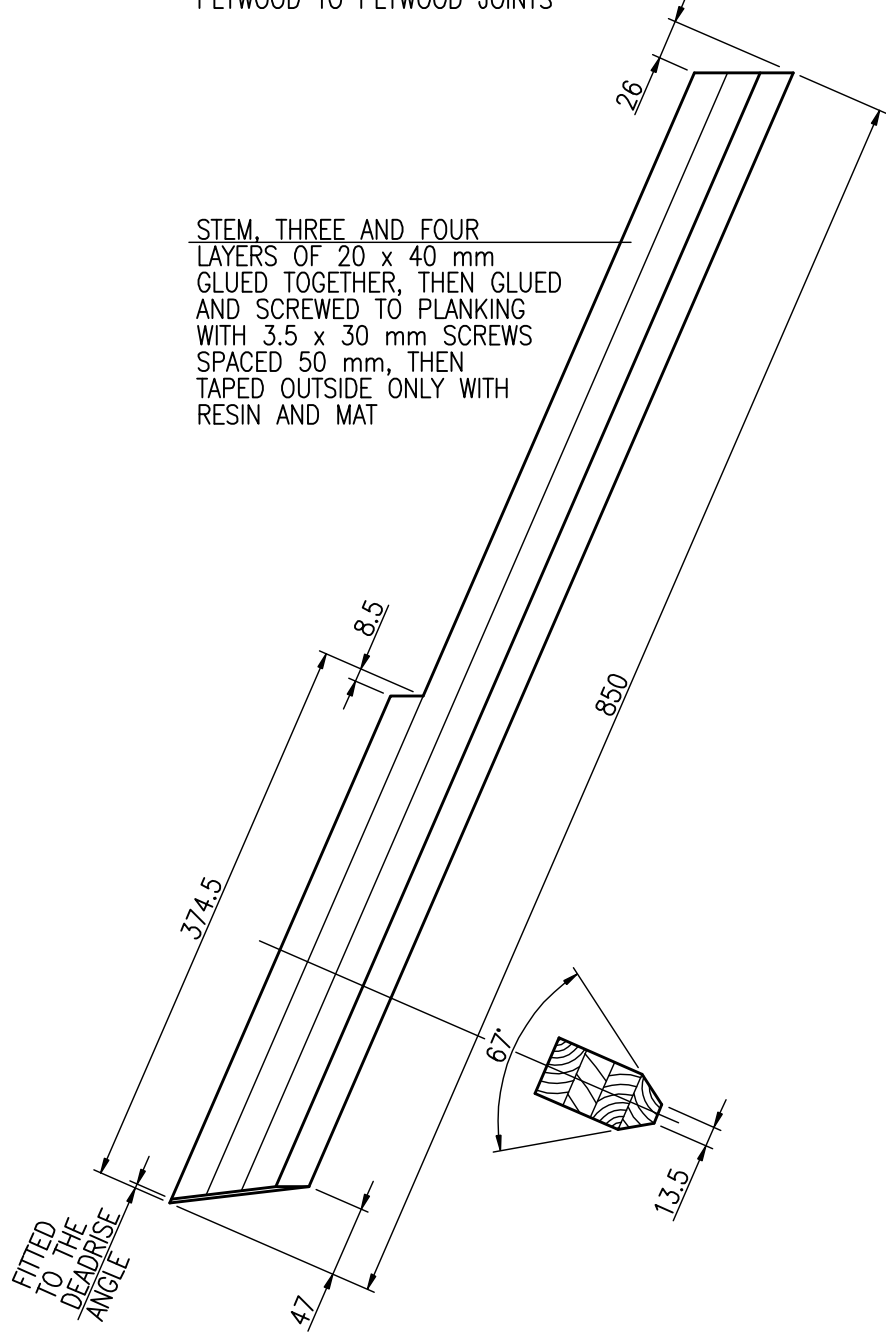

OUTER GUNWALE FASTENED TO THE STEM WITH THE 5 x 50 mm SCREW

TEMPORARY SPREADER SCREWED TO SIDES, THEN REMOVED AFTER FASTENING GUNWALES AND TAPING PLYWOOD TO PLYWOOD JOINTS

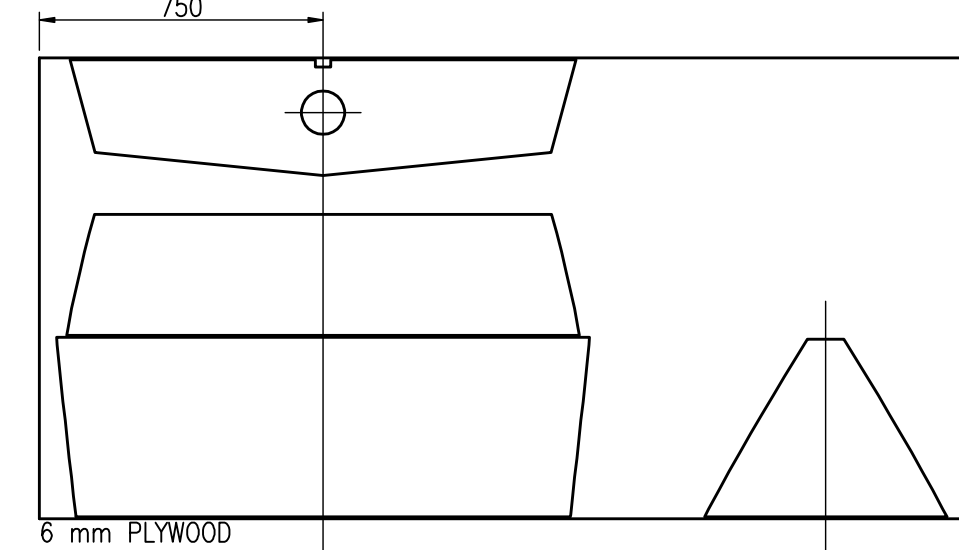
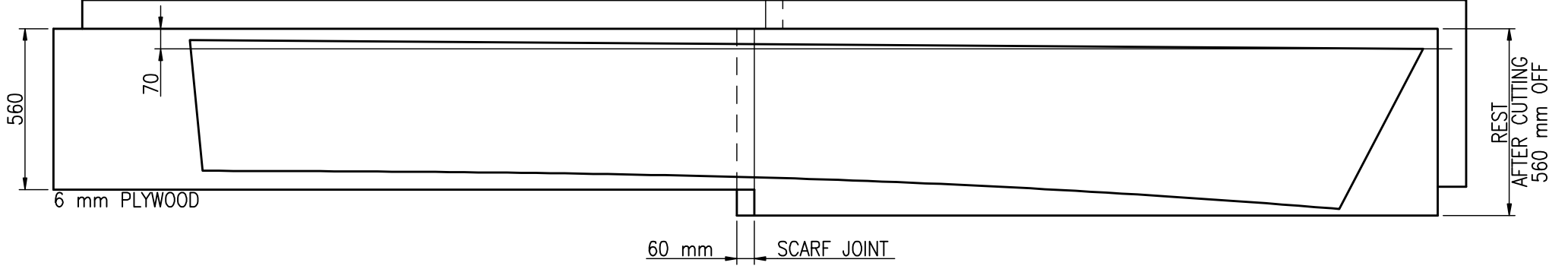

electric

HULL CONSTRUCTION
SHEET EL.3/3, SIZE A1
SCALE 1:5, 1:10, 1:20

RADOSŁAW WERSZKO
APRIL 2023, JANUARY 1925